

Aquileart®

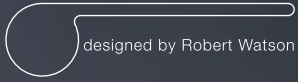

designed by Robert Watson



Aquileart® Robert Watson



ASSA ABLOY

ASSA ABLOY, the global leader
in door opening solutions

Contents

Robert Watson - History	1
Applications	2
Features and Specifications	2
Standard Finishes	2
Australian Standards Conformance	2
Levers	3
Handing	4
Escutcheons	5
Turns and Emergency Release Turns for use with Lockwood Mortice Locks	6
Turns and Emergency Release Turns for use with Lockwood A6208 Tubular Bolt	8
Latch Kits	9
Installation Fixtures	9
Powdercoat Range	11
Ordering Procedures	12
Cleaning Instructions	13



“Design is basically a response. What informs and shapes each response needs to be clearly understood, it needs to be astutely developed and the consequences as a result of the whole process must be carefully considered. From my point of view, the clearer the response, the better the design.”

Robert Watson

Winner of an Australian Design Award, Housing & Building Category 2006



reddot design award winner 2008

In 2006 the Aquileart Robert Watson Collection was afforded the honour of an Australian Design Award in the Housing & Building Category. In 2008 this innovative door furniture collection was further recognised for its design excellence by an international jury of renowned design experts as a worthy recipient of the Red Dot Award. The recognition of the Aquileart Robert Watson Collection with these awards explicitly acknowledges the creativity and innovative drive that led to its development, and pays tribute to the high quality standards inherent in the product.

The Designer

Robert Watson's career history is a diverse and wildly successful one. In his five-and-a-half years in London, he worked for not one, but two world-renowned architecture firms – Nicholas Grimshaw and Partners and Sir Norman Foster and Partners – something that is considered rare even for British architects. While at these two firms, Robert's highlights included working on The British Pavilion for the 1992 World Expo in Seville, the Valencia Congress Centre and the refurbishment of the German Reichstag in Berlin. In Australia, having worked on some major landmarks such as the MCG, Robert established his own multi-disciplined practice in 1997. Armed with degrees in both Architecture and Industrial Design, Robert continues to excel in his field to this day.

The Opportunity

Due to a competition established by Lockwood and the AIA where entrants were asked to develop an innovative new lever design, Robert researched an endless array of levers from manufacturers in Australia and overseas. He found that virtually all of them were based on the same principle. What concerned him the most was the fact that in all cases, the lever and the operating mechanism were inseparable, and therefore, levers could not be interchanged in a convenient and cost-efficient manner. This, for Robert, was an opportunity for innovation. The answer, he realised – was to liberate the lever from the operating mechanism, thus making it an independent element. He worked intensely on the project for several weeks, overcoming many operational and aesthetic challenges to develop a feasible solution.

The Solution

Robert's contribution to the Aquileart® range of levers. Carrying the hallmarks of functionality and simplicity that Robert attempts to instil in all his work, these levers complement modern residential and commercial decors equally well. The design, which requires no mounting rose, is so subtle and integrated that it looks to be in total harmony with most door surfaces. The operating mechanism is housed within a slender cylinder protruding from the door's surface. Furthermore, through his design Robert has ensured that the mounting of the lever assembly is robust enough to withstand frequent use.



ASSA ABLOY

Aquileart® Robert Watson

Description

The Robert Watson Collection of door furniture consists of three lever designs and a range of complementing escutcheons, turns and emergency release sets. The rose-less design of the furniture is unprecedented, and the innovation and lateral thinking involved in the development of the products has led to them being patent protected and design registered.

Application

The Robert Watson range is suitable for commercial as well as residential use.

It can be fitted with:

- Lockwood Synergy 3570 Series Mortice Locks
- Lockwood 6580 Mortice Locks (38mm backset, metal doors only)
- Lockwood 531 Latches and A6208 tubular bolts

Features & Specifications:

Materials

Furniture body: aluminium.

Mounting stock and other internal components: stainless steel, steel and brass.

Dimensions

Body: 36 mm diameter.

Projection from door: 62.5mm.

Fixing

Furniture is fixed to 3570 series mortice locks using a specially developed pair of steel adaptor plates that are secured through the lock case using screws. A stainless steel socket screw fixes the furniture to a stainless steel mounting stock that is in turn secured to the adaptor plates with a combination of grub screws and hexagon nuts.

Robert Watson furniture may also be fitted with a Lockwood 531 latch using a steel adaptor which locates over the body of the latch. The mounting stock and furniture are secured to the adaptor in the same way as for the mortice locks.

A special adaptor for fixing of Robert Watson furniture to 6580 narrow style mortice locks in hollow aluminium door sections is also available.

Fixings for fixed sets differ slightly from that for spring sets. Installation instructions are provided with all products.

Door Thickness

Installed with Lockwood Mortice Locks:

Minimum door thickness: 32mm

Maximum door thickness: 50mm

Installed with Lockwood 531 latches:

Minimum door thickness: 35mm

Maximum door thickness: 50mm

For doors 51 mm to 62 mm thick, use accessory pack RW00-42. (For use with mortice lock installations only).

Standard Finishes

Satin Anodised SA

Powdercoat PC

The anodised aluminium finishes are categorised as a soft finish and form part of the Lockwood Guarantee (Item 7).

Australian Standards Conformance



FIRE RATED

The Lockwood Robert Watson furniture range has been successfully fire tested up to 4 hours (depending on type of fire door) in accordance with AS1905.1:2005, Part1: Fire Resistant doorsets.

Security

The Lockwood Robert Watson door furniture conforms to the highest requirements of the Australian Lock Standard AS4145 Parts 1 & 2:2008 and achieves the highest security level when used in conjunction with an equivalent level of physical security of the lock.

Durability

The Lockwood Robert Watson furniture range conforms to the highest durability requirements level D8 of Australian Standard AS 4145.2:2008 Part 2: Mechanical locksets for doors and windows in buildings.

Corrosion Resistance

The Lockwood Robert Watson door furniture conforms to corrosion resistance requirements level C7 of Australian Standard AS 4145.2:2008 Part 2: Mechanical locksets for doors and windows in buildings.

1300 LOCK UP (1300 562 587)

lockweb.com.au

Tangent®

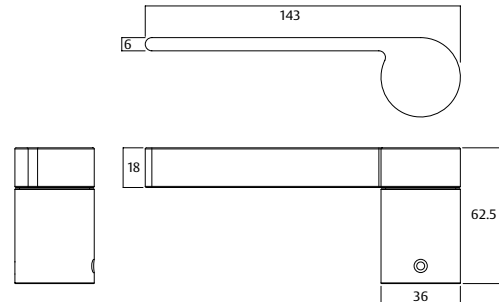
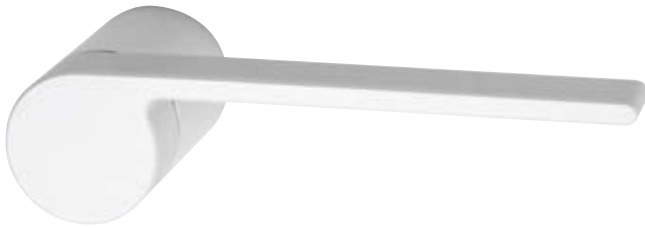

Centre

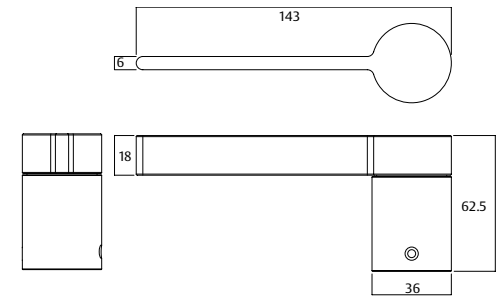
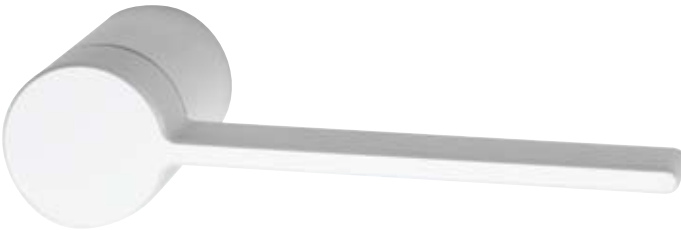

Centre D

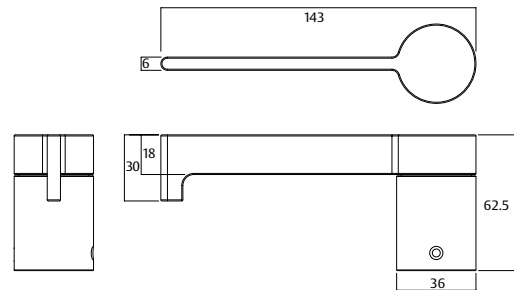

Tangent®

Architects and designers have described the Tangent as the epitome of purist design. Its revolutionary mechanism and refreshing, yet timeless look are outstanding. It is no surprise that many designers have associated this original Watson creation with the words 'stunning' and 'funky'.

Centre

The Centre follows the same minimalist approach as the original lever. Its straight, clean lines and simple form leave a lasting impression in any surrounding.

Centre D

Created specifically to meet the Commonwealth Disability Discrimination Act (DDA), the Centre D satisfies regulated functional requirements for public buildings whilst maintaining the design integrity and uniqueness evident in the Tangent and Centre.

Dimensions

Length:	143 mm
Projection:	62.5 mm
Finger Clearance:	44.5 mm

Design Registered Australia/New Zealand.

Handing – Full Set (Handing not required for full sets)

Handing – Half Set (Operating)

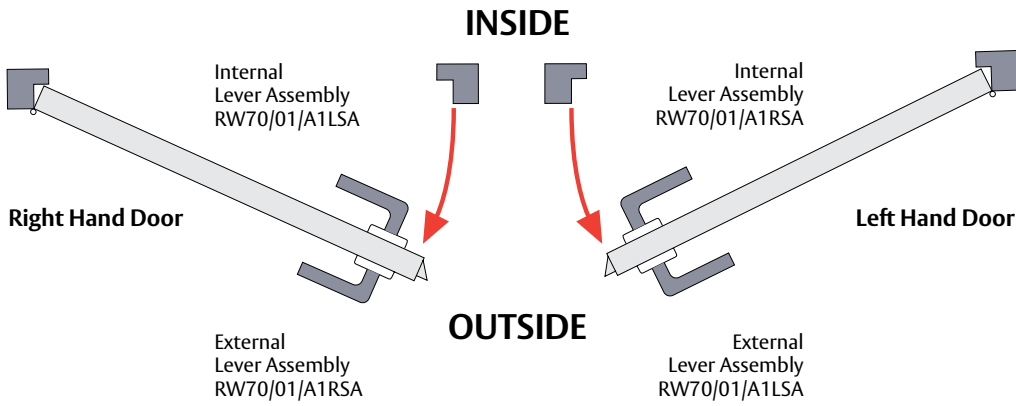

Note: Handing of furniture is as indicated on diagram irrespective of whether door is opening in or out.

Handing – Half Set (Fixed)

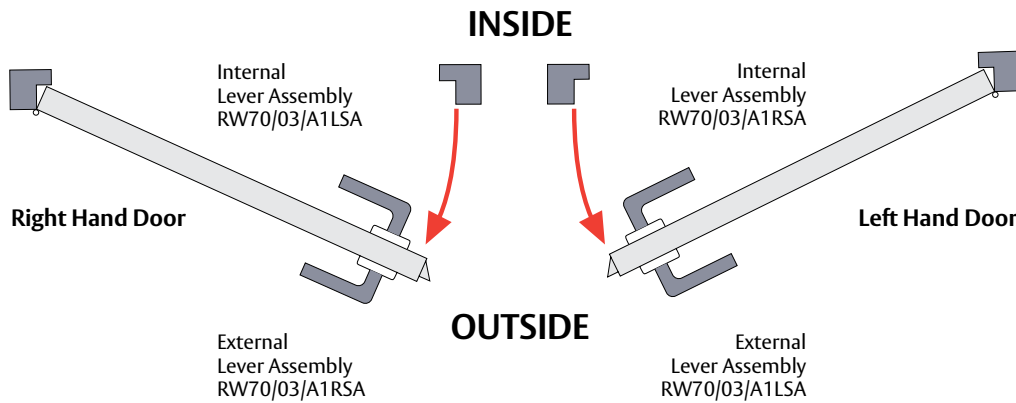

Note: Handing of furniture is as indicated on diagram irrespective of whether door is opening in or out.

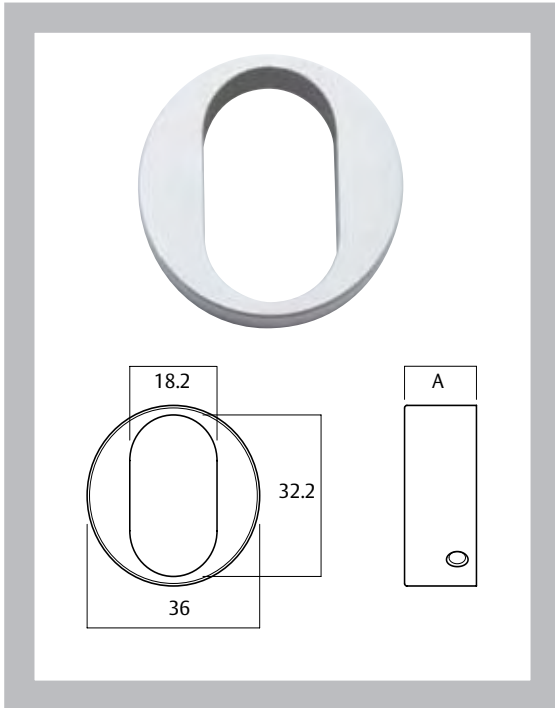

Escutcheons

These escutcheons are designed to be fitted with Lockwood oval cylinders and the Robert Watson range of turns and emergency turns. Fitted using a grub screw, they ensure that the accessories they are fitted with are aesthetically pleasing.

Use with Lockwood Mortice Locks and A6208 Bolts. The escutcheons are available in different sizes for suitability to different door thicknesses.

Note: Escutcheons must be ordered separately for use with oval cylinders, turns and emergency release turns.

Part Numbers:

Part Number	Door Thickness	(A) Dimension
RW06/38	35 – 38mm thick	17mm
RW06/44	39 – 44mm thick	14mm
RW06/50	45 – 50mm thick	11mm
RW06/56	51 – 56mm thick*	8mm
RW06/62	57 – 62mm thick*	5mm

* Extended door accessory pack required if levers are to be installed on doors of this thickness.

Accessories – use with 3570 Series and 6580 Mortice Locks

RW07 – Turn Knob

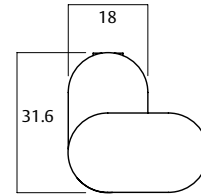
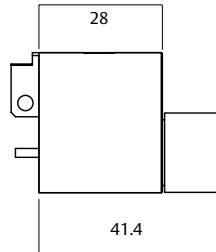

RW08 – Privacy Indicator Turn Knob

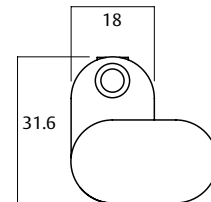
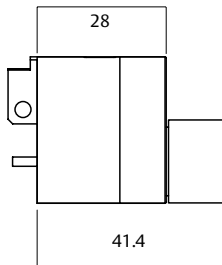

RW09 – Turn Knob and Emergency Release Set

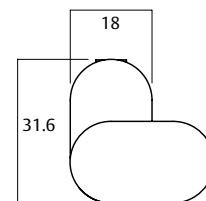
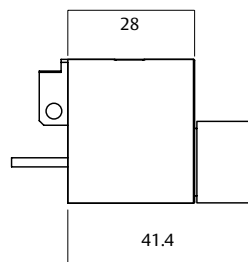
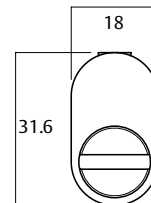
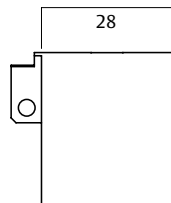

Note: Escutcheon must be ordered separately.
Refer to pg. 9 for mortice lock adaptors required.

RW10 – Turn Knob and Privacy Indicator Emergency Release Set

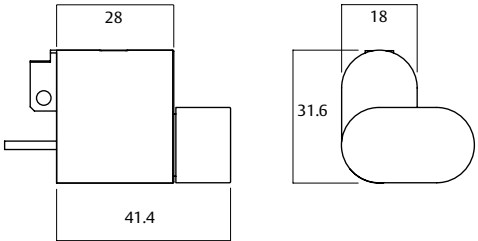
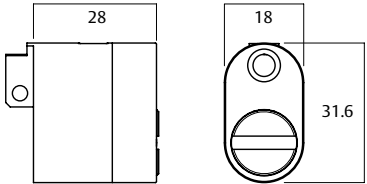

RW11 – Privacy Indicator Turn Knob and Privacy Indicator Emergency Release Set

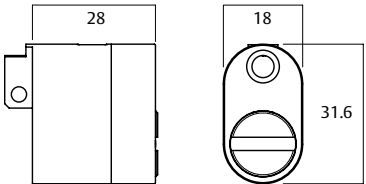
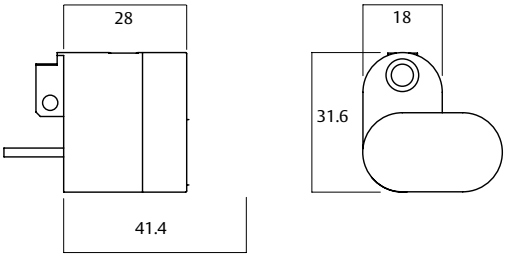

Note: Escutcheon must be ordered separately.
Refer to pg. 9 for mortice lock adaptors required.

Accessories – use with Lockwood A6208 Tubular Bolt

RW13 – Turn Knob & Emergency Release Set

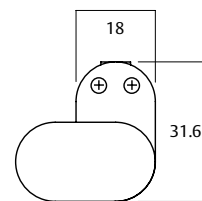
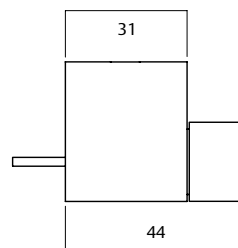
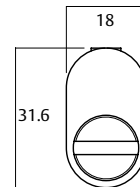
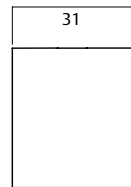

RW14 – Turn knob and Privacy Indicator Emergency Release Set

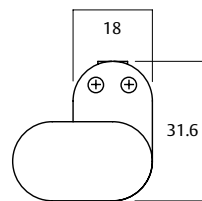
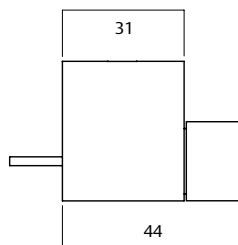
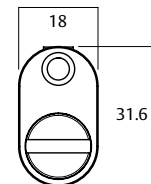
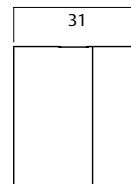

Note: Escutcheon must be ordered separately.
Refer to pg. 9 for mortice lock adaptors required.



Dulux Powdercoat Range



50279
Dulux Wedgewood Satin



33344
Dulux Horizon Blue Gloss



36603
Dulux Azure Grey Satin



32786
Dulux APO Grey Satin



81880
Dulux Special White Gloss



36858
Dulux Oyster Matt



33704
Dulux Tropics Gloss



33662
Dulux Pottery Satin



32774*
Dulux Claret Satin



32999*
Dulux Charcoal Gloss



33149
Dulux Red Earth Gloss



51032
Dulux Old Mauve Satin



32694*
Dulux Black Gloss



19319*
Dulux Black Matt



19930*
Dulux Anodic Bronze Satin



81794*
Dulux Deep Cherry Red Gloss



50068*
Dulux Deep Brunswick Green Gloss



52052*
Dulux Black Onyx Gloss



18796*
Dulux Charcoal Metallic Gloss



51275
Dulux Anotec Dark Grey Matt



32538
Dulux Stone Beige Matt

The colours represented on this chart are as close to the actual colours as modern printing processes allow.

*Technical advice should be sought, where severe ultraviolet exposure conditions exist.

Note: Consideration should be given to match Cylinder Finish.

Ordering Procedure – Lever Sets

Sample Part Number RW70/01/A1LSA is made up of several sections. Choose your product by selecting an option from each section.

For example:

Product	Use	Function	Lever	Handing	Finish
RW	70	01	A1	L	SA

Product	Function	Finish
Robert Watson RW	Operating Full Set 00	Satin Anodised SA
	Operating Half Set 01	Powdercoat PC
Use	Fixed Full Set 02	
If intended to fit using Lockwood 530 latch 30	Fixed Half Set 03	
If intended to fit using Lockwood 3570 series mortice locks 70	Lever	
If intended to fit using Lockwood 6580 narrow style mortice lock (metal door only) 80	Tangent® A1	
If intended to fit to a metal door without lock 10	Centre A2	
If intended to fit to a timber door without lock 20	Centre D A3	
	Handing (half sets only)	
	Left Handed L	
	Right Handed R	

Ordering Procedure – Escutcheons

Product	Use	Thickness	Finish
RW	06	50	SA

Product	Thickness	Finish
Robert Watson RW	Doors 57 mm – 62 mm 62	Satin Anodised SA
	Doors 51 mm – 56 mm 56	Powdercoat PC
Use	Doors 45 mm – 50 mm 50	
06	Doors 39 mm – 44 mm 44	
	Doors 35 mm – 38 mm 38	

Ordering Procedure – Turn Knobs and Emergency release turns (For use with Lockwood Mortice Locks).

Product	Function	Finish
RW	07	SA

Product	Function	Finish
Robert Watson RW	Turn Knob 07	Satin Anodised SA
	Privacy Indicating Turn Knob 08	Powdercoat PC
	Turn Knob & Emergency Release Set 09	
	Turn Knob/Privacy Indicating Emergency Release Set 10	
	Privacy Indicating Turn Knob & Privacy Indicating Emergency Release Set 11	

Ordering Procedure – Turn Knob and Emergency release turns (For use with Lockwood A6208 tubular bolts).

Product	Function	Finish
RW	13	SA

Product	Function	Finish
Robert Watson RW	Turn Knob & Emergency Release Set 13	Satin Anodised SA
	Turn Knob & Privacy Indicating Emergency Release Set 14	Powdercoat PC

Ordering Procedure – Latch Kits

Product	Latch	Backset	Finish
RW	531	60	SC

Product	Backset	Finish
Robert Watson RW	60mm backset 60	Satin Chrome SC
	70mm backset 70	
	127mm backset 127	

Latch	
Plainlatch 531	

Latch Kits are supplied with adaptor to enable use with Robert Watson Furniture.

Note:

- Locks and latches must be ordered separately from furniture;
- Select powdercoat colour from chart on page 11;
- The information contained in this catalogue refers to ordering of furniture and latches only;
- For ordering procedures on Mortice Locks refer to either Catalogue 3570 Series Cylinder Mortice Locks (AAA-CAT-032) or 3580 Series Cylinder Mortice Lock Collection (AAA-CAT-060).

Specification Service

For all Architectural hardware specification assistance refer to your local ASSA ABLOY Sales Office.

A fully comprehensive, obligation free, Architectural Door Hardware specification can be prepared by Architectural Hardware Representatives.

Quality Endorsed Company

SAI Global operates a program which assesses the quality procedures and capabilities of an organisation in terms of the requirements of specific Australian and International



Standards for Quality Systems. Following assessment by SAI Global, ASSA ABLOY Australia Pty Limited, 235 Huntingdale Rd, Oakleigh VIC 3166 have been granted a certificate

of registration as a quality endorsed company complying with the requirements of AS 3902/ISO 9001 – Quality Systems for Production and Installation.

Disclaimer

Whilst every effort has been made to ensure that the information contained in this catalogue is accurate at the time of publication, ASSA ABLOY recommends that you consult ASSA ABLOY or its agents prior to placing an order to ascertain current information on specific products, as ASSA ABLOY reserves the right to make changes without notice. ASSA ABLOY will not be liable for any injury, loss or damage whatsoever, arising from any errors or omissions in the information contained in the catalogue or arising from the use or application of the information contained herein. This catalogue does not constitute an offer for the sale of any particular product.

Lockwood Guarantee and Care & Maintenance

Please go to lockweb.com.au for details on Lockwood Guarantee and product care & maintenance.

ASSA ABLOY is the global leader in door opening solutions, dedicated to satisfying end-user needs for security, safety and convenience



ASSA ABLOY



Lockwood is the leading brand in the Australian locking industry. With an established reputation for high quality products, this iconic brand provides a wide range of locking solutions to residential housing, commercial building and industrial application markets. Lockwood is supported by an extensive distribution and after-sales support network. Our customers include retailers, architects, trade and industrial personnel, locksmiths and security dealers.

ASSA ABLOY

ASSA ABLOY is the global leader in door opening solutions, dedicated to satisfying end-user needs for security, safety and convenience.

ASSA ABLOY is represented in all major regions, in both mature and emerging markets, with leading positions in Australia, Europe and North America.

As the world's leading lock group, ASSA ABLOY offers a more complete product range of door opening solutions than any other company in the market.

Australia
1300 LOCK UP (1300 562 587)
lockweb.com.au

New Zealand
Telephone +64 9415 7888
assaabloy.co.nz

ASSA ABLOY Australia Pty Limited
235 Huntingdale Road,
Oakleigh Victoria, 3166
Australia

info.au@assaabloy.com
assaabloy.com.au

ASSA ABLOY New Zealand Ltd.
6 Armstrong Road
Albany, North Shore City, 0632
New Zealand

info.nz@assaabloy.com
assaabloy.co.nz

