

Insulated architectural wall façade panel systems - KS1000 AWP

Available in 3 profiles Micro-Rib (MR), Mini-Rib (MM) and Euro-Box (EB)

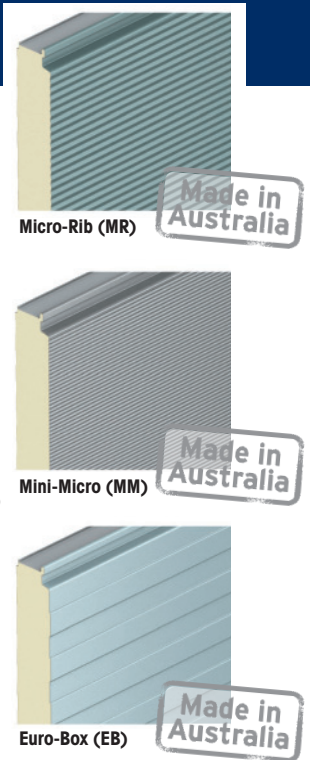
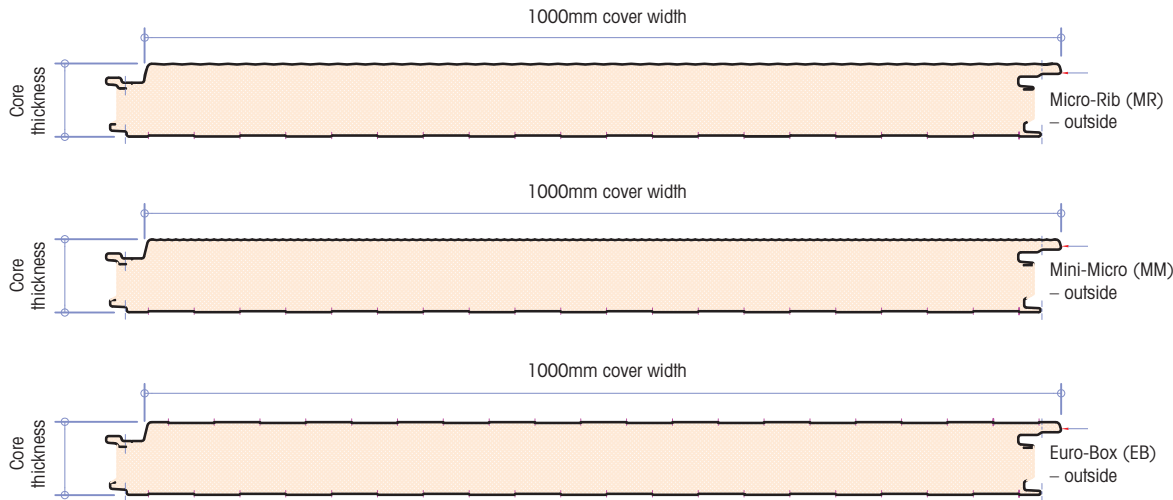

Core thickness (mm)	50	80
R-Value (m ² K/W)	2.65	4.15
Weight kg/m ² 0.5/0.4 steel	11.2	12.4

Deflection Ratio

Pressure = Span/100

Suction = Span/100

Unfactored Load/Span Table (Use calculated design windload values unfactored)

SPAN CONDITION	Panel Thickness (mm)	Load Type	Uniformly Distributed Loads (kPa) Span L in Metres															
			2.0	2.2	2.4	2.6	2.8	3.0	3.2	3.4	3.6	3.8	4.0	4.2	4.4	4.6	4.8	5.0
SINGLE SPAN Outer Sheet 0.5mm steel Inner Sheet 0.4mm steel L	50	Pressure/ Suction	4.00	3.38	2.89	2.48	2.14	1.85	1.62	1.41	1.24	1.10	0.97	-	-	-	-	-
	80	Pressure/ Suction	7.39	6.38	5.55	4.85	4.25	3.75	3.32	2.95	2.63	2.35	2.11	1.90	1.71	1.55	1.40	1.28
DOUBLE SPAN Outer Sheet 0.5mm steel Inner Sheet 0.4mm steel L L	50	Pressure/ Suction	4.59	4.01	3.25	3.12	2.78	2.48	2.23	2.01	1.82	1.64	1.49	1.66	1.24	1.14	1.04	0.96
	80	Pressure/ Suction	7.99	7.05	6.27	5.61	5.04	4.56	4.14	3.77	3.44	3.15	2.89	2.66	2.45	2.27	2.10	1.94

Vertical Joint Options

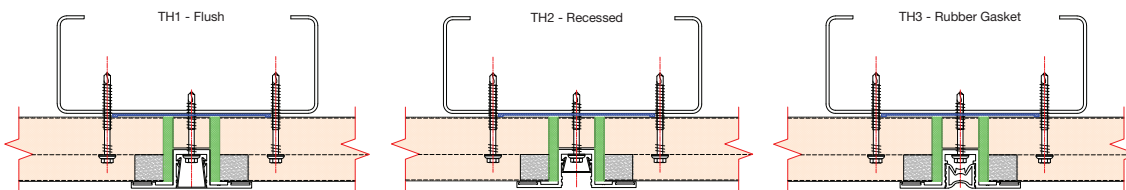

Note:
Number of fixings determined by
fastener calculation - contact
Technical Services for further
information.

For further technical information, please contact Kingspan Technical Services on 1300 799 594.

Kingspan Insulated Panels Pty Limited
 Tel 02 9673 5069 Fax 02 9673 5068
 Email info@kingspanpanels.com.au
 www.kingspan.com.au

